

ADM Building Capacities and Projections Packet

2022-23 Facility Master Planning Committee Session #2

ADM Community Schools Forecasted Enrollment By Level

																	Enrollment Totals			
Period	Year	PS	PK	K	1st	2nd	3rd	4th	5th	6th	7th	8th	9th	10th	11th	12th	ES	MS	HS	District
Past	2017/18	42	23	134	163	147	152	153	149	151	135	120	130	129	118	124	1,114	255	501	1,870
	2018/19	41	26	143	144	165	151	154	153	150	155	137	124	137	125	114	1,127	292	500	1,919
	2019/20	45	25	170	146	151	173	153	173	165	155	163	136	124	134	128	1,201	318	522	2,041
	2020/21	41	26	182	171	148	149	176	160	172	164	160	164	131	126	138	1,225	324	559	2,108
	2021/22	41	26	143	185	169	154	157	178	166	170	172	170	160	128	127	1,219	342	585	2,146
First 5-Year	2022/23	50	26	165	147	188	172	157	162	182	169	177	176	168	157	130	1,249	346	631	2,226
	2023/24	50	26	158	170	150	192	173	162	166	186	177	183	175	165	159	1,247	363	682	2,292
	2024/25	75	26	178	163	173	153	193	178	166	169	194	182	180	171	167	1,305	363	700	2,368
	2025/26	100	26	171	183	165	176	154	199	183	169	177	201	181	177	174	1,357	346	733	2,436
	2026/27	100	26	166	176	186	169	179	160	204	187	178	182	199	179	179	1,366	365	739	2,470
Last 5-Year	2027/28	100	26	174	168	181	192	175	192	167	205	202	185	178	193	182	1,375	407	738	2,520
	2028/29	100	26	181	183	174	187	200	186	199	173	217	208	186	174	197	1,436	390	765	2,591
	2029/30	100	26	169	188	189	176	188	206	189	201	178	220	203	180	173	1,431	379	776	2,586
	2030/31	100	26	185	173	193	196	185	201	214	196	212	183	218	203	181	1,473	408	785	2,666
	2031/32	100	26	176	188	177	200	200	196	208	218	210	220	184	215	207	1,471	428	826	2,725

Source: RSP & Associates, LLC 2021/22 Student Forecast Model

Adel Elementary: Capacity Projections (General Education Classrooms)

Adel Elementary	2022-23	2023-24	2024-25	2025-26	2026-27	2027-28	2028-29	2029-30	2030-31	2031-32
Total General Education Rooms (No PK and No PS) Available	24	24	23	23	22	22	22	22	22	22
Kindergarten General Education Rooms Available	12	12	12	12	11	11	11	11	11	11
Kindergarten Projected Enrollment	165	158	178	171	166	174	181	169	185	176
First Grade General Education Rooms Available	12	12	11	11	11	11	11	11	11	11
First Grade Projected Enrollment	147	170	163	183	176	168	183	188	173	188
Total K-1 Projected Enrollment (No PK)	312	328	341	354	342	342	364	357	358	364
Desired: General Education Capacity	468	468	448	448	429	429	429	429	429	429
Functional: General Education Capacity	540	540	517	517	495	495	495	495	495	495
Maximum: General Education Capacity	600	600	575	575	550	550	550	550	550	550
PreSchool Rooms Available	2	2	3	3	4	4	4	4	4	4
Preschool Rooms Capacity (Capacity Divided AM/PM)	48	48	72	72	96	96	96	96	96	96
PK Rooms Available	2	2	2	2	2	2	2	2	2	2
PK Capacity (13 Per Room)	26	26	26	26	26	26	26	26	26	26
								Desired	Functional	Maximum
							Kindergarten	19	22	25
							First Grade	20	23	25
							PreSchool	24	NA	NA
							PK	13	NA	NA

Note: Calculations based off general education classrooms available. Does not include library, art, music, gym, special education classrooms, or other common spaces.

Adel Elementary General Education Classrooms

KEY

- General Education Classrooms (24)
- Pre-Kindergarten Classrooms (2)
- PreSchool Classrooms (2)

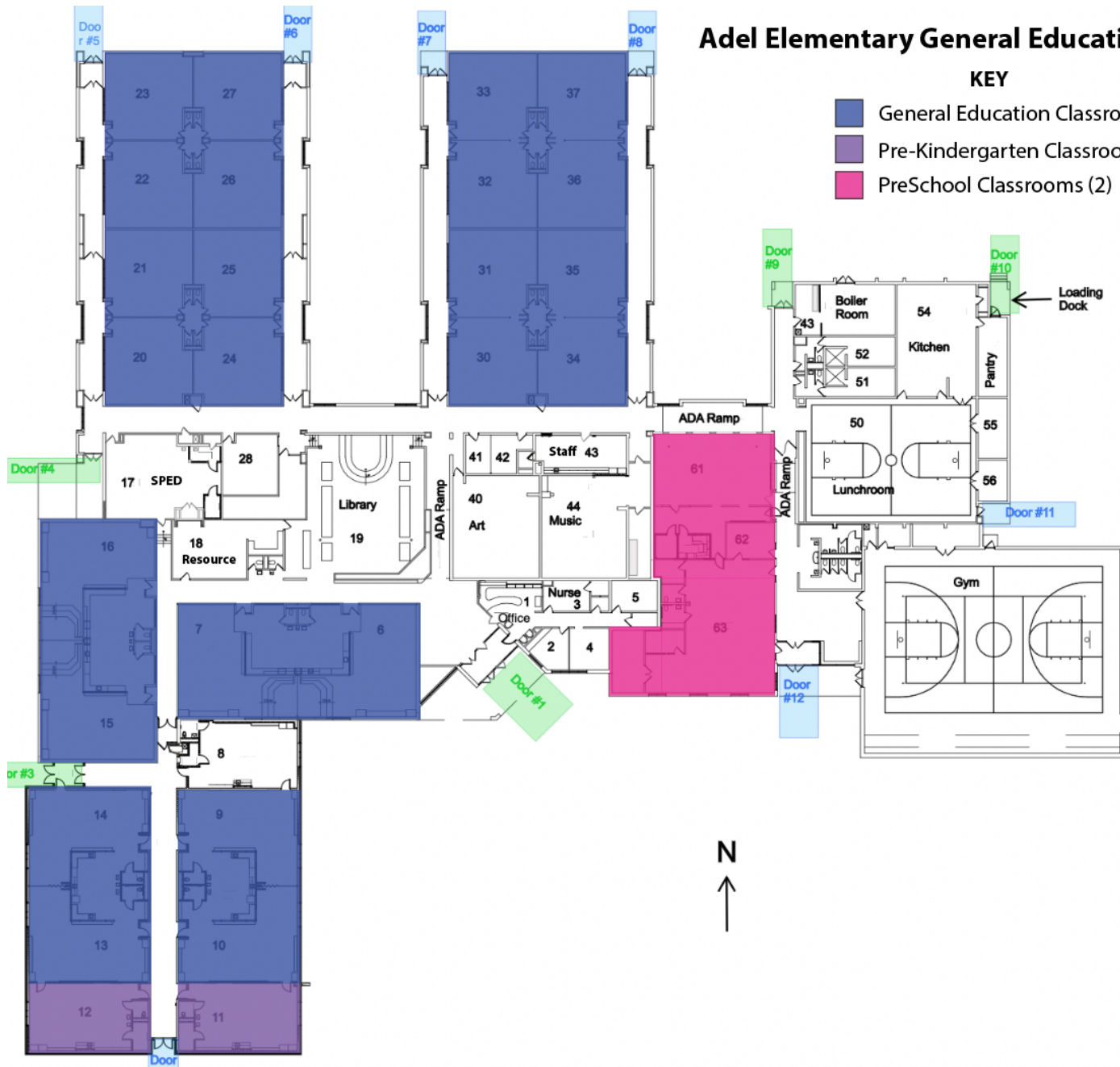

Meadow View Elementary: Capacity Projections (General Education Classrooms)

Meadow View Elementary	2022-23	2023-24	2024-25	2025-26	2026-27	2027-28	2028-29	2029-30	2030-31	2031-32
Total General Education Rooms Available	30	30	30	30	30	30	30	30	30	30
2nd Grade General Education Rooms Available	10	10	10	10	10	10	10	10	10	10
2nd Grade Projected Enrollment	188	150	173	165	186	181	174	189	193	177
3rd Grade General Education Rooms Available	10	10	10	10	10	10	10	10	10	10
3rd Grade Projected Enrollment	172	192	153	176	169	192	187	176	196	200
4th Grade General Education Rooms Available	10	10	10	10	10	10	10	10	10	10
4th Grade Projected Enrollment	157	173	193	154	179	175	200	188	185	200
Total 2-4 Projected Enrollment	517	515	519	495	534	548	561	553	574	577
Desired: General Education Capacity	650	650	650	650	650	650	650	650	650	650
Functional: Education Capacity	690	690	690	690	690	690	690	690	690	690
Maximum: General Education Capacity	750	750	750	750	750	750	750	750	750	750
								Desired	Functional	Maximum
						2nd Grade		21	23	25
						3rd Grade		22	23	25
						4th Grade		22	23	25

Note: Calculations based off general education classrooms available. Does not include library, art, music, gyms, flex room, special education classrooms, or other common spaces.

Program Spaces

- Administration
- Arts
- Circulation
- Classrooms
- Collaboration
- Media Center
- Phys Ed
- Service
- Support Services



DeSoto Intermediate: Capacity Projections (General Education Classrooms)

DeSoto Intermediate	2022-23	2023-24	2024-25	2025-26	2026-27	2027-28	2028-29	2029-30	2030-31	2031-32
Total General Education Rooms	24	24	24	24	24	24	24	24	24	24
5th Grade General Education Rooms	12	12	12	12	12	12	12	12	12	12
5th Grade Projected Enrollment	162	162	178	199	160	192	186	206	201	196
6th Grade General Education Rooms	12	12	12	12	12	12	12	12	12	12
6th Grade Projected Enrollment	182	166	166	183	204	167	199	189	214	208
Total 5-6 Projected Enrollment	344	328	344	382	364	359	385	395	415	404
Desired: General Education Capacity	552	552	552	552	552	552	552	552	552	552
Functional: General Education Capacity	576	576	576	576	576	576	576	576	576	576
Maximum: General Education Capacity	600	600	600	600	600	600	600	600	600	600
								Desired	Functional	Maximum
						5th Grade		23	24	25
						6th Grade		23	24	25

Note: Calculations based off general education classrooms available. Does not include library, art, music, band, gym, special education classrooms, or other common spaces.

DeSoto Intermediate General Education Classrooms

KEY

General Education Classrooms (24)

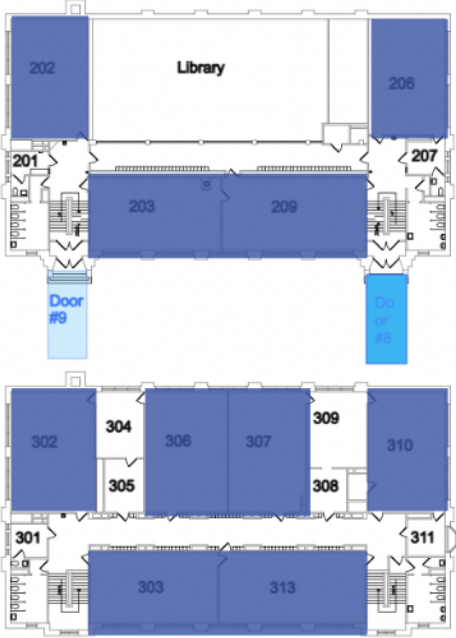

ADM Middle School: Capacity Projections (General Education Classrooms)

ADM Middel School	2022-23	2023-24	2024-25	2025-26	2026-27	2027-28	2028-29	2029-30	2030-31	2031-32
Total General Education Rooms	25	25	25	25	25	25	25	25	25	25
Grade 7 Projected Enrollment	169	186	169	169	187	205	173	201	196	218
Grade 8 Projected Enrollment	177	177	194	177	178	202	217	178	212	210
Total 7-8 Projected Enrollment	346	363	363	346	365	407	390	379	408	428
Desired: General Education Capacity	575	575	575	575	575	575	575	575	575	575
Functional: General Education Capacity	600	600	600	600	600	600	600	600	600	600
Maximum: General Education Capacity	625	625	625	625	625	625	625	625	625	625
							Grade	Desired	Functional	Maximum
							7-8	23	24	25

Note: Calculations based off general education classrooms available. Does not include library, art, band, choir, gym, special education classrooms, or other common spaces.

ADM Middle School General Education Classrooms (First Floor)

KEY

General Education Classrooms (13)

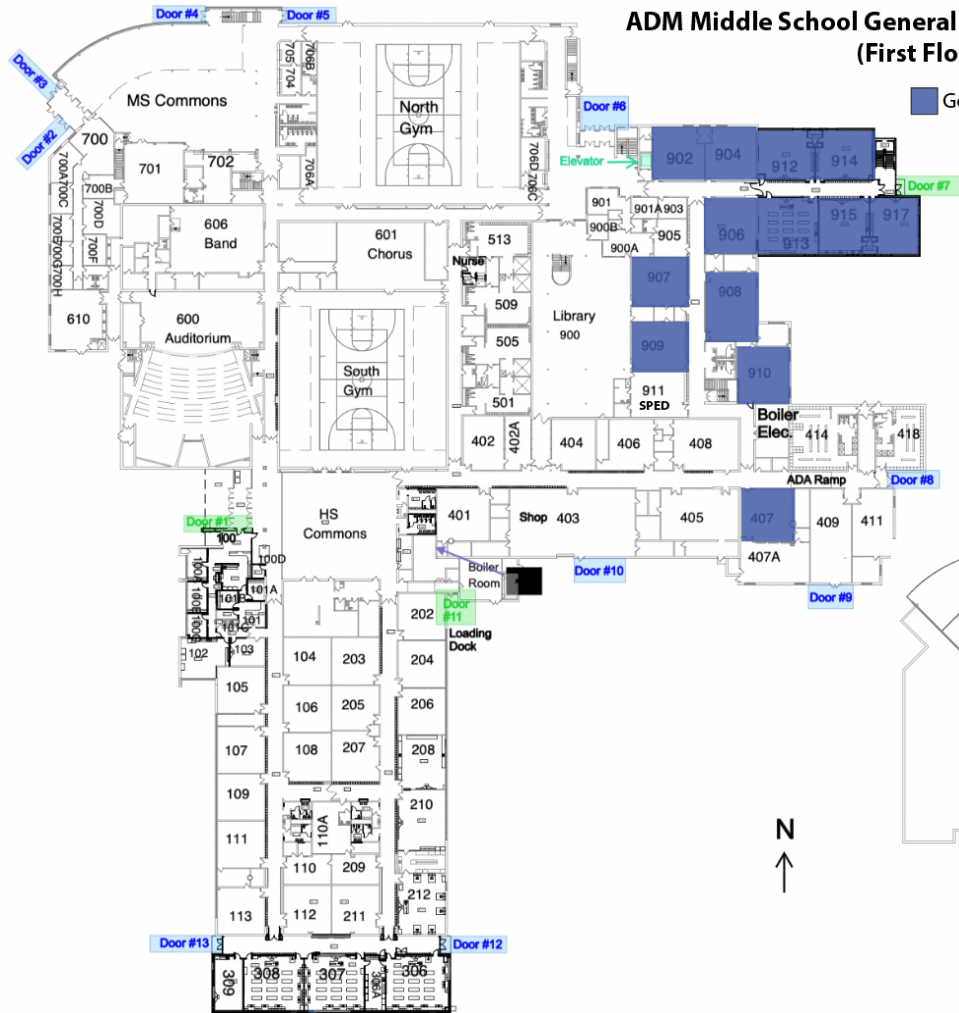

ADM Middle School General Education Classrooms (Second Floor)

KEY

General Education Classrooms (12)

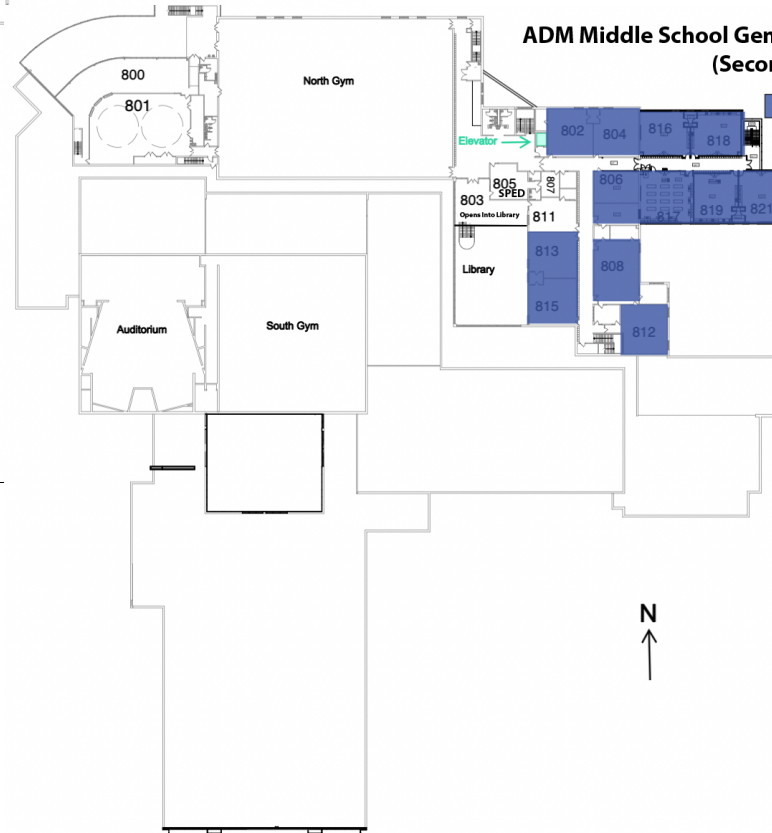

ADM Middle School: 2018 Study of Capacities and Projections

ADM Middel School	2022-23	2023-24	2024-25	2025-26	2026-27	2027-28	2028-29	2029-30	2030-31	2031-32
Grade 7 Projected Enrollment	169	186	169	169	187	205	173	201	196	218
Grade 8 Projected Enrollment	177	177	194	177	178	202	217	178	212	210
Total 7-8 Projected Enrollment	346	363	363	346	365	407	390	379	408	428
Desired: General Education Capacity	462	462	462	462	462	462	462	462	462	462
Functional: General Education Capacity	507	507	507	507	507	507	507	507	507	507
Maximum: General Education Capacity	552	552	552	552	552	552	552	552	552	552

Note: Calculations based off [RSP and Associates 2018 Capacity Study](#)

This Page Is Intentionally Blank

ADM High School: Capacity (General Education Classrooms)

ADM High School	2022-23	2023-24	2024-25	2025-26	2026-27	2027-28	2028-29	2029-30	2030-31	2031-32
Total General Education Rooms	24	24	24	24	24	24	24	24	24	24
Grade 9 Projected Enrollment	176	183	182	201	182	185	208	220	183	220
Grade 10 Projected Enrollment	168	175	180	181	199	178	186	203	218	184
Grade 11 Projected Enrollment	157	165	171	177	179	193	174	180	203	215
Grade 12 Projected Enrollment	130	159	167	174	179	182	197	173	181	207
Total 9-12 Projected Enrollment	631	682	700	733	739	738	765	776	785	826
Desired: General Education Capacity	552	552	552	552	552	552	552	552	552	552
Functional: General Education Capacity	576	576	576	576	576	576	576	576	576	576
Maximum: General Education Capacity	600	600	600	600	600	600	600	600	600	600
Note: Calculations based off general education classrooms available. Does not include library, art, band, choir, gym, strength and conditioning, locker rooms, special education classrooms, FCS rooms, agriculture classroom, computer science classroom, CTE classrooms, or other common spaces.							Grade	Desired	Functional	Maximum
							9-12	23	24	25

ADM High School General Education Classrooms

KEY

General Education Classrooms (24)

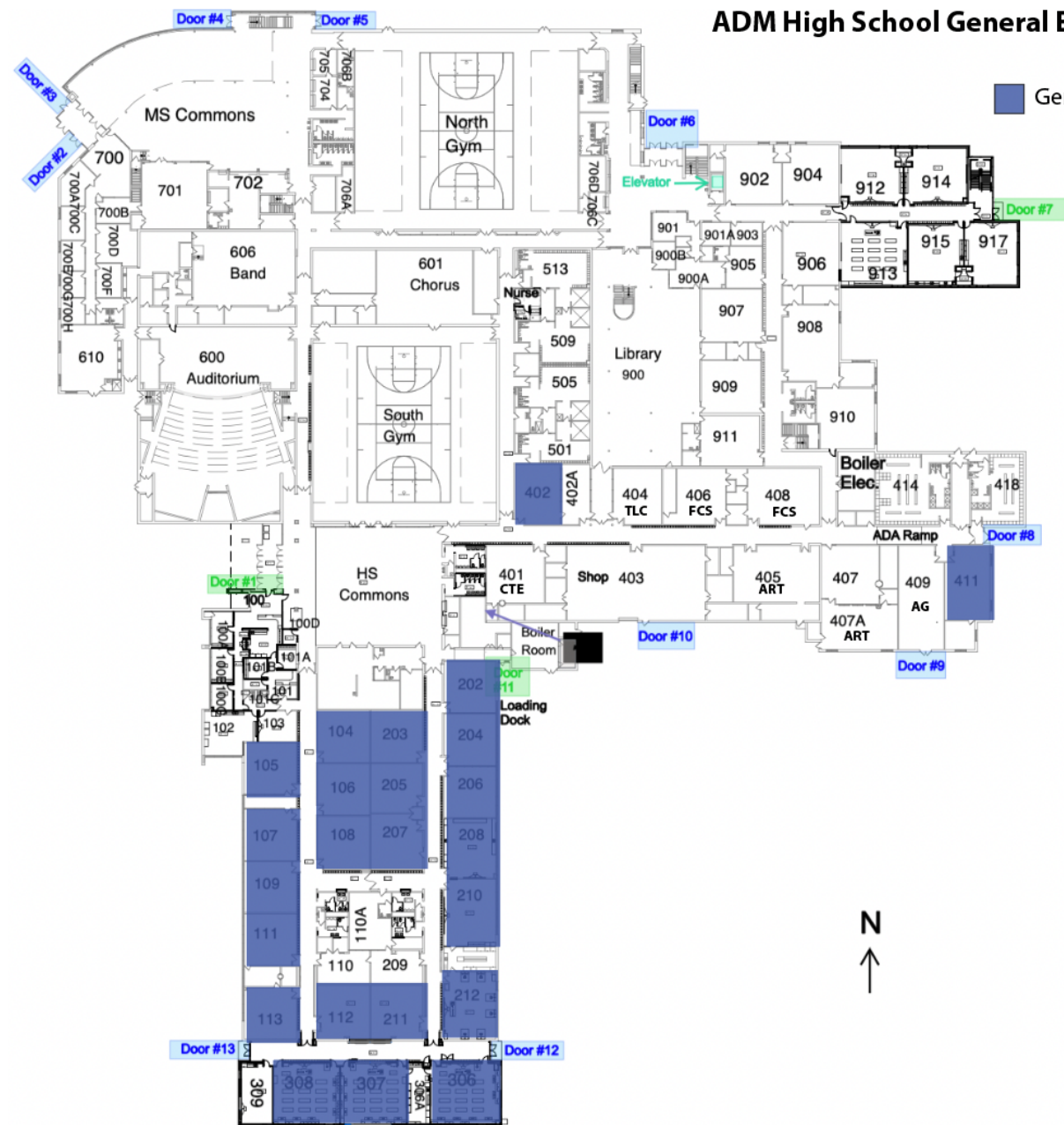

ADM High School: Capacity (All Classrooms)

ADM High School	2022-23	2023-24	2024-25	2025-26	2026-27	2027-28	2028-29	2029-30	2030-31	2031-32
Total All Classrooms Rooms	35	35	35	35	35	35	35	35	35	35
Grade 9 Projected Enrollment	176	183	182	201	182	185	208	220	183	220
Grade 10 Projected Enrollment	168	175	180	181	199	178	186	203	218	184
Grade 11 Projected Enrollment	157	165	171	177	179	193	174	180	203	215
Grade 12 Projected Enrollment	130	159	167	174	179	182	197	173	181	207
Total 9-12 Projected Enrollment	631	682	700	733	739	738	765	776	785	826
Desired: General Education Capacity	805	805	805	805	805	805	805	805	805	805
Functional: General Education Capacity	840	840	840	840	840	840	840	840	840	840
Maximum: General Education Capacity	875	875	875	875	875	875	875	875	875	875
Note 1: Calculations based off all classrooms available. Does not include special education classrooms, auditorium, locker rooms, or library.							Grade	Desired	Functional	Maximum
							9-12	23	24	25

Note 2: This calculation assumes that all classrooms will be filled with the same number of students across all programs at the High School - something that does not actually occur due to programming, student choice and selection of elective courses. (Example: The same number of students in an elective computer science course as in a required science course)

Strength and Conditioning
(2nd Level)

ADM High School All Classrooms

KEY

■ All Classrooms (35)



ADM High School: 2018 Study of Capacities and Projections

ADM High School	2022-23	2023-24	2024-25	2025-26	2026-27	2027-28	2028-29	2029-30	2030-31	2031-32
Grade 9 Projected Enrollment	176	183	182	201	182	185	208	220	183	220
Grade 10 Projected Enrollment	168	175	180	181	199	178	186	203	218	184
Grade 11 Projected Enrollment	157	165	171	177	179	193	174	180	203	215
Grade 12 Projected Enrollment	130	159	167	174	179	182	197	173	181	207
Total 9-12 Projected Enrollment	631	682	700	733	739	738	765	776	785	826
Desired: General Education Capacity	697	697	697	697	697	697	697	697	697	697
Functional: General Education Capacity	765	765	765	765	765	765	765	765	765	765
Maximum: General Education Capacity	832	832	832	832	832	832	832	832	832	832

Note: Calculations based off [RSP and Associates 2018 Capacity Study](#)

This Page Is Intentionally Blank

ADM High School: Capacity (Square Feet Per Student)

ADM High School	2022-23	2023-24	2024-25	2025-26	2026-27	2027-28	2028-29	2029-30	2030-31	2031-32
Total Square Feet	98100	98100	98100	98100	98100	98100	98100	98100	98100	98100
Grade 9 Projected Enrollment	176	183	182	201	182	185	208	220	183	220
Grade 10 Projected Enrollment	168	175	180	181	199	178	186	203	218	184
Grade 11 Projected Enrollment	157	165	171	177	179	193	174	180	203	215
Grade 12 Projected Enrollment	130	159	167	174	179	182	197	173	181	207
Total 9-12 Projected Enrollment	631	682	700	733	739	738	765	776	785	826
ADM HS Square Feet Per Student	155	144	140	134	133	133	128	126	125	119
Comparable High Schools				Larger Metro Schools						
Ballard High School (Current Estimate)		334		DCG High School (Current Estimate)		259				
North Polk High School (Current Estimate)		255		Johnston High School (Current Estimate)		206				
Carlisle High School (Current Estimate)		236		Waukee High School (Current Estimate)		288				
Bonderant High School (Current Estimate)		225		Waukee Northwest High School (Current Estimate)		298				
Carroll High School (Current Estimate)		218		Norwalk High School (Current Estimate)		291				
Average		253.6		Average		268.4				
Other Metrics						Note: Calculations of ADM square feet include locker rooms, weight room, wrestling room, auditorium, 50% of band room, 50% of cafeteria, and 50% of library.				
A4LE (formerly CFPI) Reccomended		225								
North Carolina 2016 Target		181								
2006 National Average HS Square Feet Per Student		167								
2008 National Center for Ed States		160								
Average		183.3								

Note: Calculations of ADM square feet per student include all locker rooms, weight room, wrestling room, common spaces, auditorium, 50% of band room, 50% of vocal music room, and 50% of library.

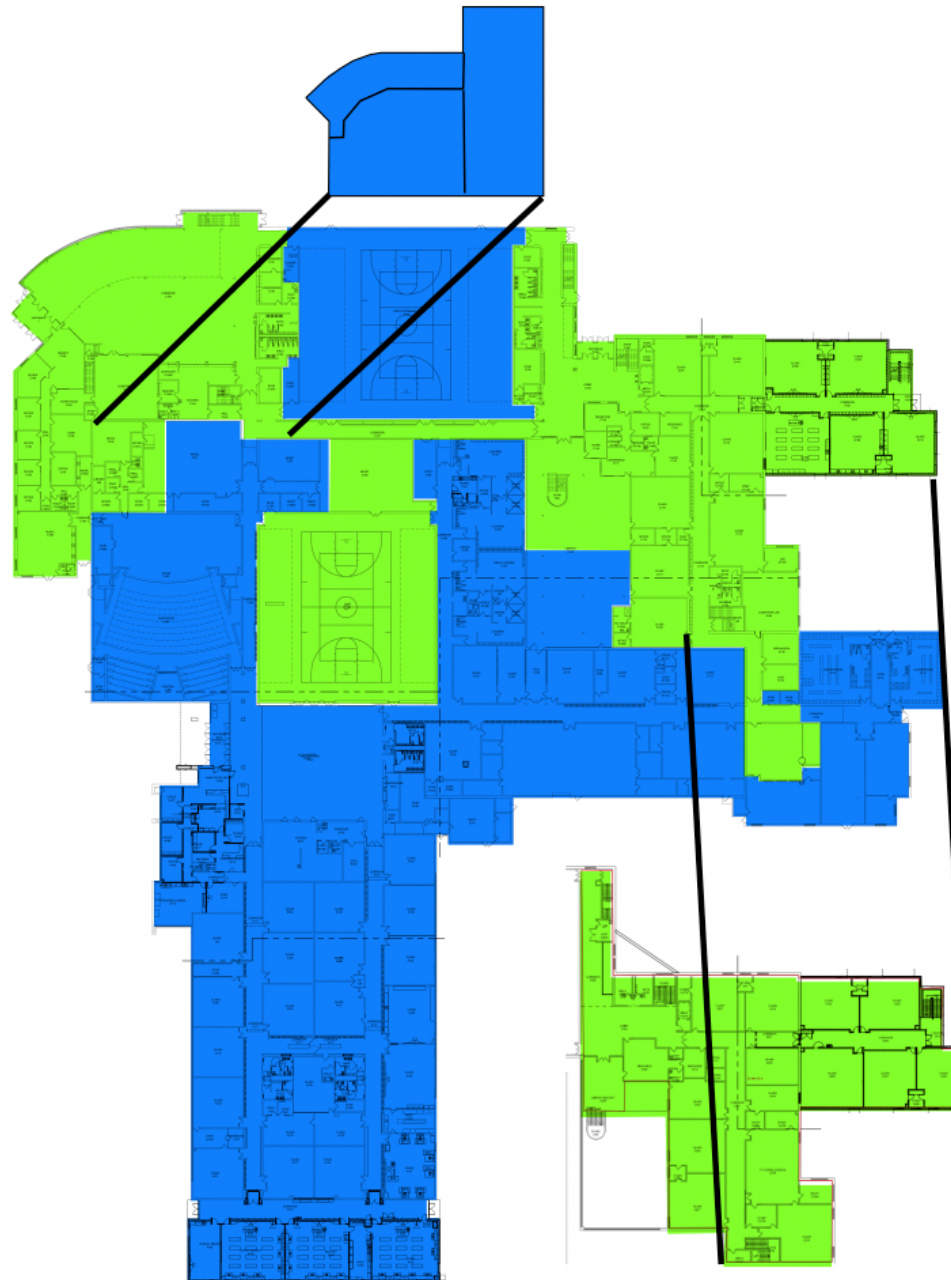

- **HIGH SCHOOL PROGRAM AREA (98,100 Square Feet)**
- **MIDDLE SCHOOL PROGRAM AREA (83,850 Square Feet)**