

GROUND FLOOR PLAN

SCALE: NOT TO SCALE

DESOTO INTERMEDIATE INFORMATION

- TOP NUMBER: DISTRICT IDEAL FOR STUDENTS PER CLASSROOM
- MIDDLE NUMBER: DISTRICT MAXIMUM FOR STUDENTS PER CLASSROOM
- BOTTOM NUMBER: SF/STUDENT (IN PARENTHESES: BELOW NATIONAL AVERAGE)

INFORMATION

DISTRICT IDEAL:

- 3RD: 18-19 PER CLASS
- 4TH-5TH: 20-22 PER CLASS

NATIONAL AVERAGE SF/STUDENT:

- 3RD: 50 SF/STUDENT
- 4TH-5TH: 50 SF/STUDENT

DESOTO INTERMEDIATE BUILDING CAPACITY:

- AT DISTRICT IDEAL: 337 STUDENTS
- AT DISTRICT MAX: 369 STUDENTS (IDEAL PLUS 2 STUDENTS PER CLASSROOM)

DRAWING KEY

- CLASSROOM SIGNIFICANTLY UNDERSIZED
- CLASSROOM UNDERSIZED
- SPACES FOR POSSIBLE RENOVATION

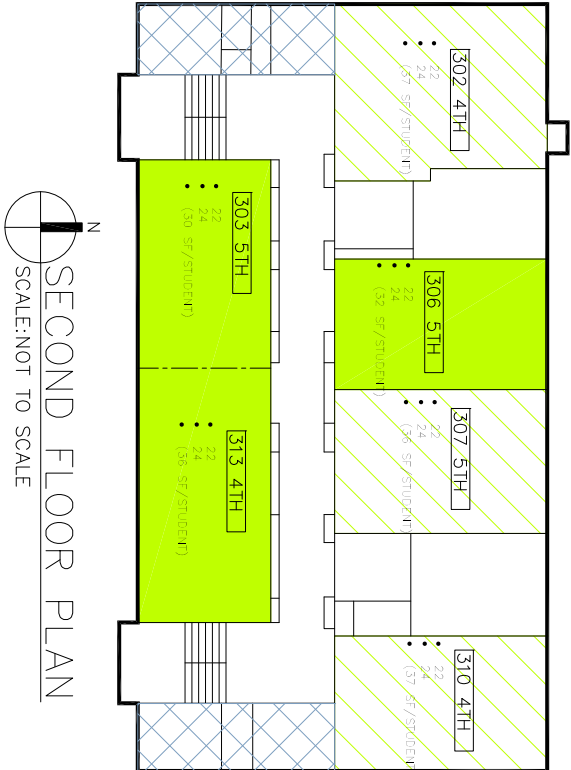

SECOND FLOOR PLAN

SCALE: NOT TO SCALE

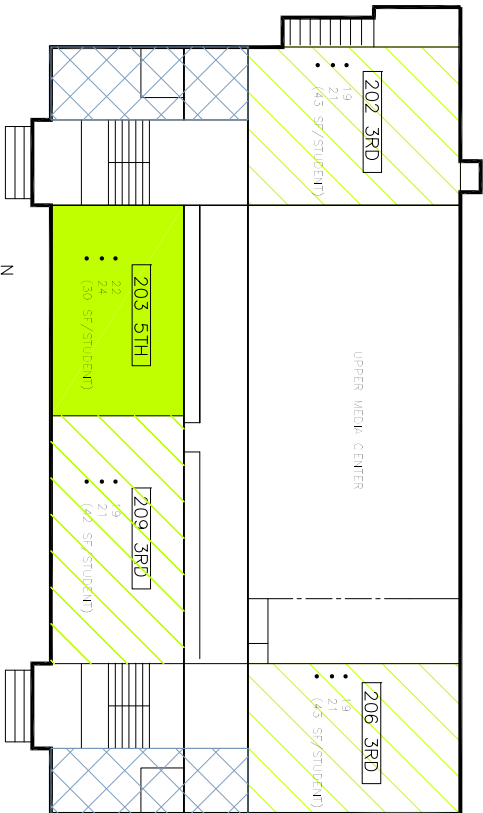

FIRST FLOOR PLAN

SCALE: NOT TO SCALE

DESOTO INTERMEDIATE